

MKS-L DIES CONSTRUCTION SHEET

JST

Terminal/Contact Model No.		SXH-001T-P0.6	Die set Model No.	SXH-001-06
			Applicator Model No.	MKS-L
			Crimp shape (wire)	N-1.5
			Crimp shape (ins)	N-1.8
Clearance between Crimper (B) and Shear blade 0.1				
Description	No.	Description	No.	
Crimper (A)	63510	Crimper anvil (A)	75720	
Crimper (B)	64440	Crimper anvil (B)	76580	
Spacer (A)	65080			
Spacer (B)				
Spacer (C)				
Punch	68042	Spacer	77190	
Die holder		Shear blade	74030	
Spring		Shear blade supporter	73030	
Wire block	387	Shear blade base	78010	
Insulation block	324	Shear blade spring	87010	
		Feed finger	86180	
		Feed finger holder	86040	
Guide plate (L)	81270	Stripper	91320	
Guide plate (R)	82163	Stripper bracket	92230	
Feed plate	84230	Stripper pin		
Pressure plate	83061			
Pressure spring(2pcs)	87001	Scrap cover	95151	
Remarks				
Wire and Crimp height				
Wire	Type	Size	Crimp height (mm)	Ins
	UL1007	#28	0.60~0.65	2
	UL1007	#26	0.65±0.05	2
	UL1007	#24	0.70±0.05	2.1
	UL1007	#22	0.75±0.05	2.2

Prepared by

H. Fujii

Issue date

Jun 04, 1996

JST

Side-Feeding Applicator

MKS-L

Die Set Assembly

Applicable
terminal/
contact

SXH-001-06

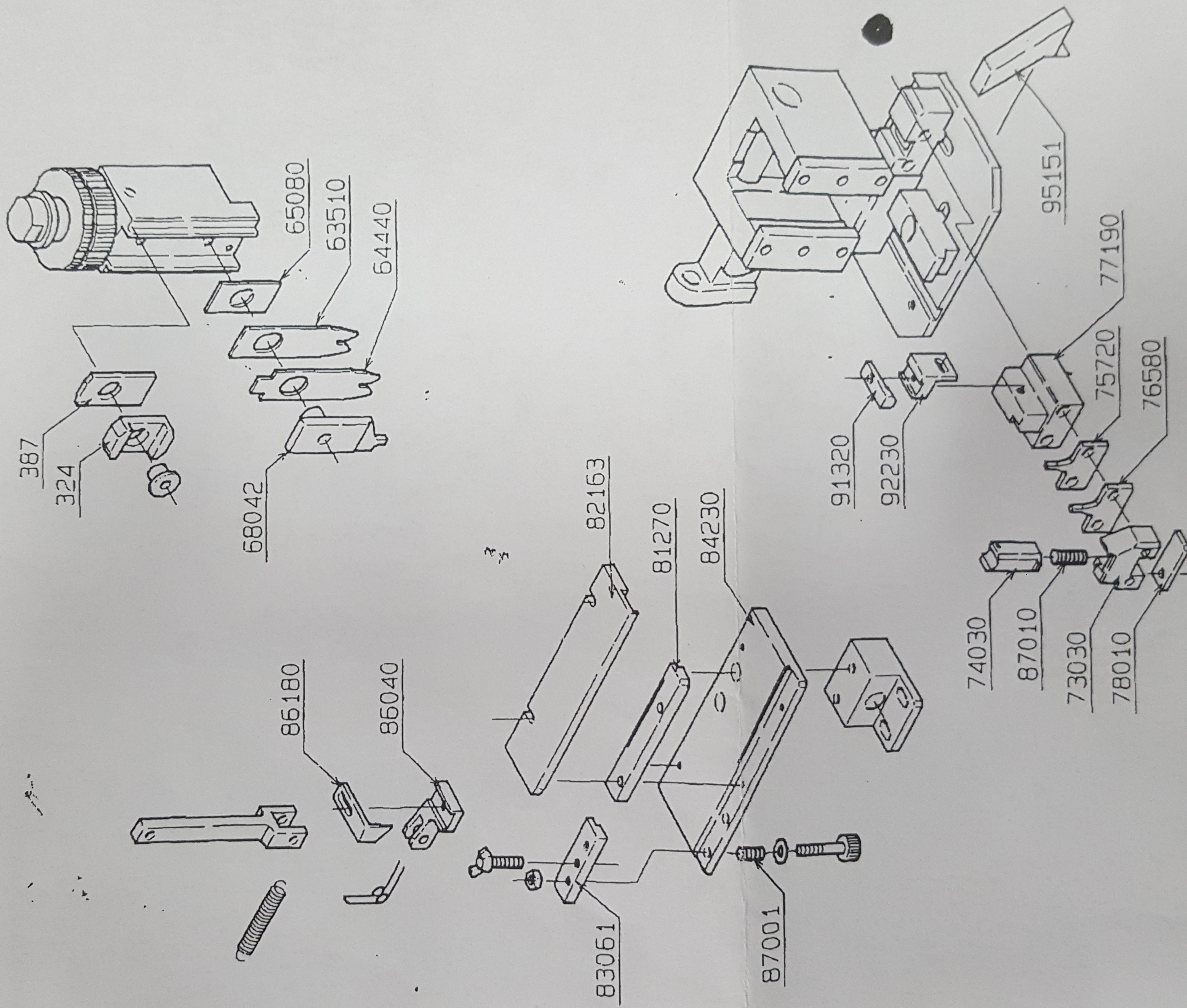

Date	Drawn by
Cur 1975	J. G. ...

(CP-MS181)