

MKS-L DIES CONSTRUCTION SHEET

JST

Terminal/Contact Model No.	SVH-21T-(P) 1.1	Die set Model No.	SVH-21-11
		Applicator Model No.	MKS-L
		Crimp shape (wire)	N-1.8
		Crimp shape (ins)	N-2.6

Clearance between Crimper (B) and Shear blade 0.1

Description	No.	Description	No.
Crimper (A)	63641	Crimper anvil (A)	75790
Crimper (B)	64155	Crimper anvil (B)	76420
Spacer (A)	65050		
Spacer (B)	65012		
Spacer (C)			
Punch	68270	Spacer	77240
Die holder	67680	Shear blade	74240
Spring	87100	Shear blade supporter	73030
Wire block	390	Shear blade base	78010
Insulation block	328	Shear blade spring	87010
		Feed finger	86050
		Feed finger holder	86040
Guide plate (L)	81430	Stripper	91930
Guide plate (R)	82440	Stripper bracket	92470
Feed plate	84260	Stripper pin	D2100
Pressure plate	83130		
Pressure spring(2pcs)	87001	Scrap cover	95151

Wire and Crimp height				Remarks
Wire		Crimp height (mm)		
Type	Size	Wire	Ins	
UL1007	#22	1.05±0.05	2.3	
UL1007	#20	1.10±0.05	2.4	
UL1007	#18	1.15±0.05	2.6	

Prepared by	<i>A. Fujii</i>	Issue date	Apr 01, 1996
Checked by		No.	CD-MC171

JST

Side-Feeding Applicator

MKS-L

Die Set Assembly

Rev. 5-2-11

Applicable
terminal/
contact

SVH-21-11

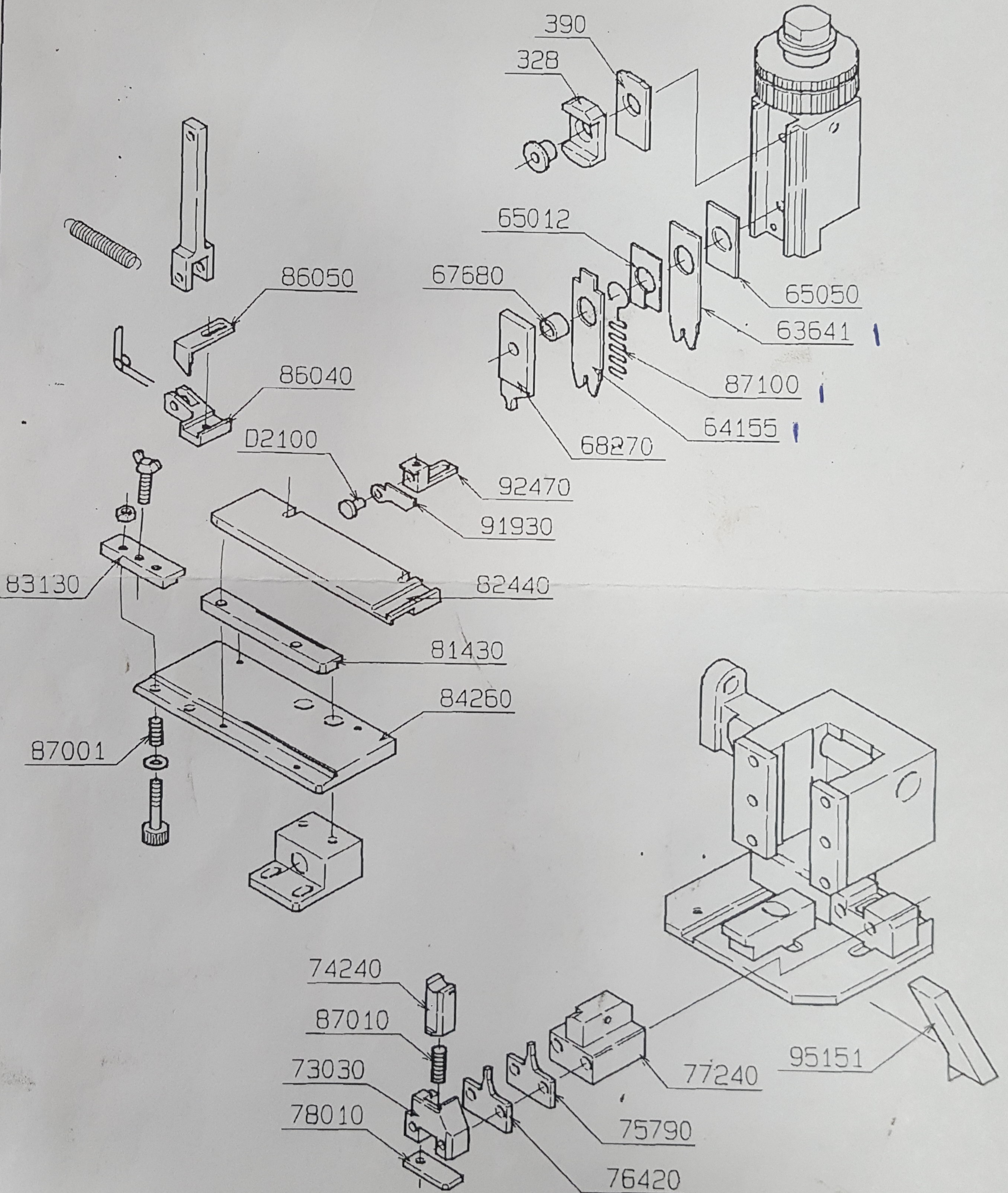

Date	Drawn by
<i>Aug. 5, 1973</i>	<i>[Signature]</i>

(CP-MS171)